



Owner's Manual Supplement

For your safety and comfort, read carefully and keep in the vehicle.

HILUX

Applicable to Rugged X
and Rogue Models



TOYOTA MOTOR CORPORATION AUSTRALIA LIMITED

A.B.N. 64 009 686 097

© 2020 TOYOTA MOTOR CORPORATION AUSTRALIA LIMITED

All rights reserved. This material may not be reproduced or copied, in whole or part, without the written permission of Toyota Motor Corporation Australia Limited, 155 Bertie Street, Port Melbourne, Victoria.

Pictorial index

Search by illustration

1

Driving

Operations and advice which are necessary for driving

2

Maintenance

Caring for your vehicle and maintenance procedures

3

Vehicle specifications

Vehicle specifications, etc.

4

Index

Search alphabetically

For your information	4
Reading this manual	5
Pictorial index	6

1 Driving

1-1. LED Driving lights	9
1-2. Snorkel.....	10
1-3. Recovery points	11
1-4. Tow bar	14
1-5. Sports bar	15
1-6. Heavy duty rock rails	16
1-7. Roller cover and resin sports bar.....	17
1-8 12 volt power socket - tub	22
1-9. Tub tray and tailgate protection	24
1-10. Textile liner	25

2 Maintenance and care

2-1. Cleaning and protection of the vehicle.....	26
---	----

3 Vehicle specifications

3-1. Vehicle specifications.....	29
3-2. Maintenance data	30

4 Index

For your information

Owner's Manual Supplement

This supplement manual is designed to be read in conjunction with the main Owner's Manual. To the extent that information in the main Owner's Manual and this Supplement Manual are inconsistent, the information in this Supplement Manual should be preferred.

Please note that this manual applies to a range of Hilux models and may include optional equipment, therefore you may find some sections of this manual will not apply to your vehicle.

All specifications provided in this manual are current at the time of printing. However, because of the Toyota policy of continual product improvement, we reserve the right to make changes at any time without notice. Depending on your vehicle's specifications and optional equipment, the vehicle shown in the illustrations may differ from your vehicle.

Reading this manual



WARNING:

Explains something that, if not obeyed, could cause death or serious injury to people.



NOTICE:

Explains something that, if not obeyed, could cause damage to or a malfunction in the vehicle or its equipment.



1 2 3 ... Indicates operating or working procedures. Follow the steps in numerical order.



Indicates the action (pushing, turning, etc.) used to operate switches and other devices.



Indicates the outcome of an operation (e.g. a lid opens).

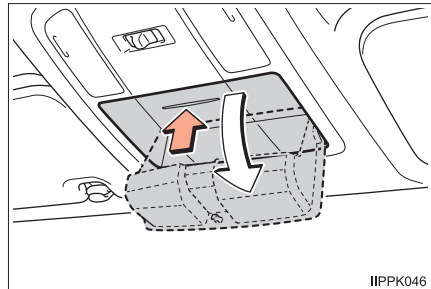

Indicates the component or position being explained.



Means "Do not", "Do not do this", or "Do not let this happen".

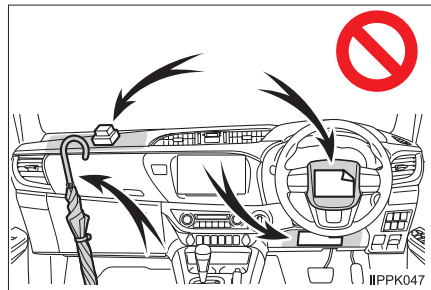

Pictorial index

■ Exterior: Rugged X

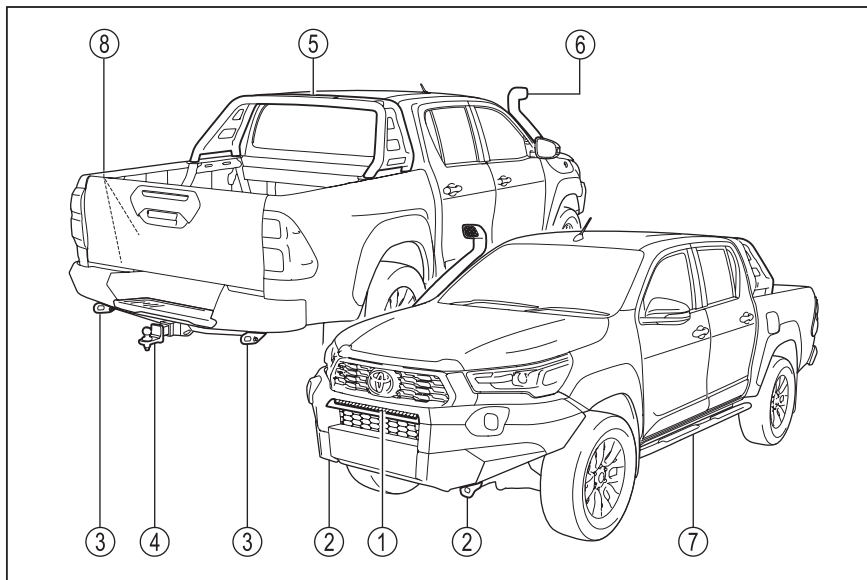

① LED Driving lights	9
② Recovery points (Front).....	12
③ Recovery points (Rear)	13
④ Tow bar	14
⑤ Sports bar	15
⑥ Snorkel.....	10
⑦ Heavy duty rock rails.....	16
⑧ Tub tray and tailgate protection	24

Pictorial index

■ Exterior: Rogue

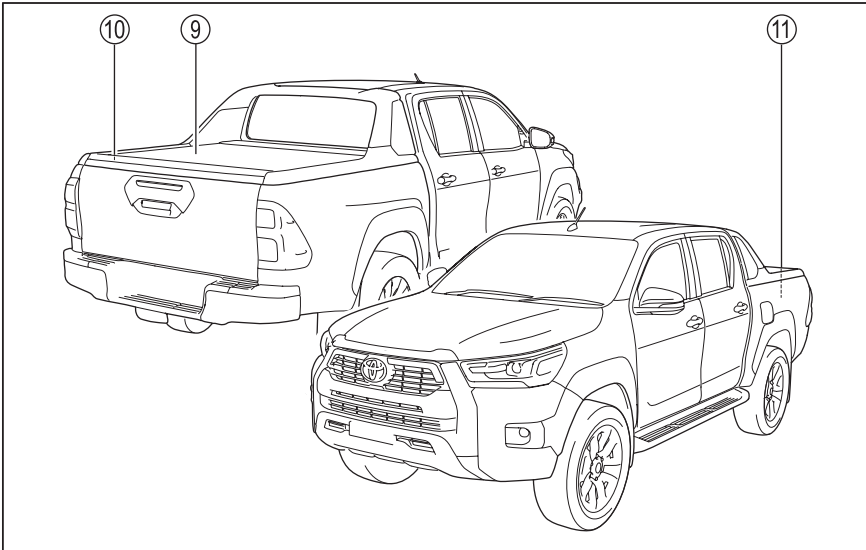

- ⑨ Roller cover and resin sports bar 17
- ⑩ 12 volt power socket - tub 22
- ⑪ Textile liner 25

Pictorial index

■ Interior

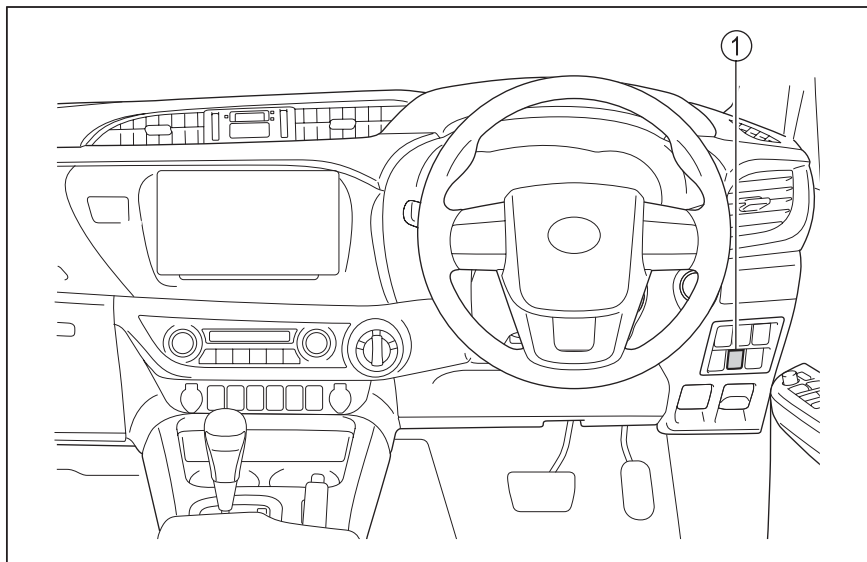

- ① LED Driving lights switch 9

LED Driving lights (if equipped)

Turning on the LED driving lights

With the high beam lights on, press the LED driving light switch.

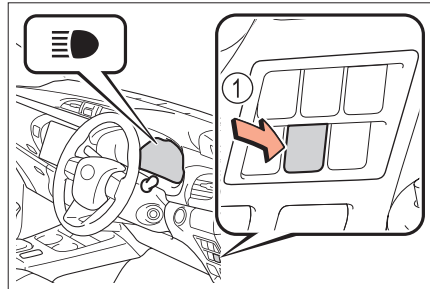

Turning off the LED driving lights

Turn off the LED driving lights by either:

- ① Press the driving light switch to turn off the lights.
- ② Switch off high beam*.

*NOTE: Driving lights will turn back on automatically when high beam is activated.

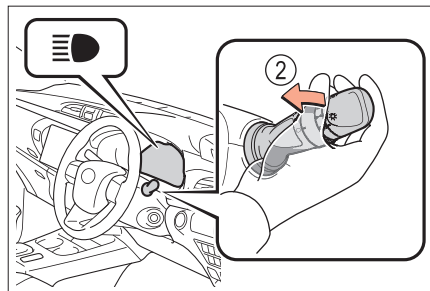

LED light bar levelling

Vertical aiming of the central light bar can be adjusted to suit loading conditions of the vehicle.

- ① Raises the level of the light beam.
- ② Lowers the level of the light beam.

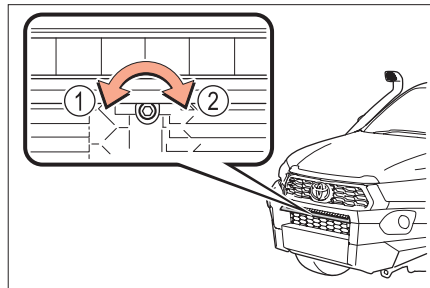

Snorkel (if equipped)

Your vehicle may be fitted with a snorkel.

The snorkel, with its higher air-entry height, is designed to provide cleaner air to the engine in dusty conditions.

The snorkel head should be forward-facing for normal driving to ensure optimum engine performance.

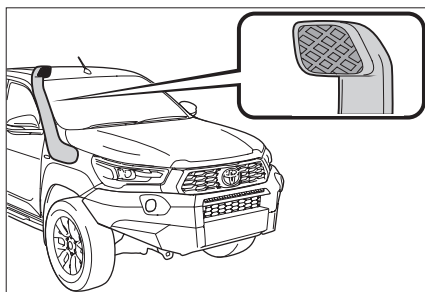

Rotating the snorkel head

The snorkel head should be rotated to face rearwards during prolonged or heavy rainstorm, snowstorm, insect swarms or extremely dusty driving conditions to minimise foreign material intake to the engine air inlet system.

To rotate the snorkel head, loosen the 2 screws at the base of the head to disengage them from the main snorkel body (do not fully remove the screws from the head as they are designed to be retained to avoid loss).

Lift the snorkel head off and rotate it 180° to face rearwards, refit and re-tighten the screws.



NOTICE

- Avoid directing water into the ram head opening during vehicle washing.
- Periodically check to ensure the drainage holes underneath the snorkel are open/clear.
- The snorkel does not increase the vehicle's water wading depth capability.

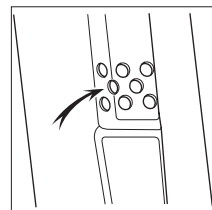

Care instructions

- ① Do not wash the snorkel surfaces using abrasive sponges.
- ② Avoid application of any cutting or polishing compound to the snorkel surface to prevent surface discolouration/markings.
- ③ Avoid directing water into the ram head opening during vehicle washing.
- ④ Periodically check to ensure the drainage holes underneath the snorkel are open/clear.

Recovery points (if equipped)

WARNING

Death, serious injury and vehicle damage could occur if the recovery points are used incorrectly.

Do not use recovery points if any parts are bent or bolts are loose. Any such parts must be replaced at your Toyota Dealer.

Always follow manufacturer's instructions in relation to the fitment of recovery devices to the recovery points.

Incorrect fitment or usage may result in potential whip of recovery device and unintended or uncontrolled movement of the vehicle(s).

Vehicle recovery has risks which need to be assessed and managed before every recovery operation to ensure the safety of all persons in and near the vehicle(s).

Your vehicle may be fitted with recovery points.

Always follow these instructions along with the manufacturer's instructions when using after market products with the recovery points.

It is recommended to use the recovery points with a snatch strap or a winch:

- Only use a snatch strap with a minimum rating of 8000kg
- Only use a winch with maximum capacity up to 6800kg (15000lb)

Fitting bow shackle

We recommend using a bridle connected by two 3.2t or two 4.75t rated bow shackles.

When fitting the shackle, pass the eye of the shackle through the recovery point slot. The pin should pass through the recovery strap or bridle, and not the recovery point slot (see diagram).

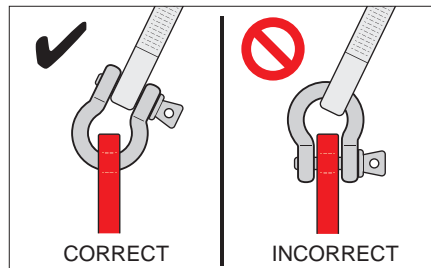

Front recovery points

Front recovery points are located on either side of the bullbar. They are designed to distribute the large recovery loads through the chassis frame.

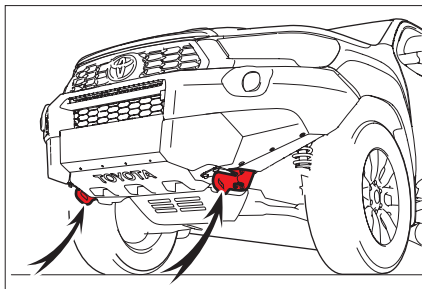

The recovery points are designed to be used in unison, using a bridle to spread the load between both points.

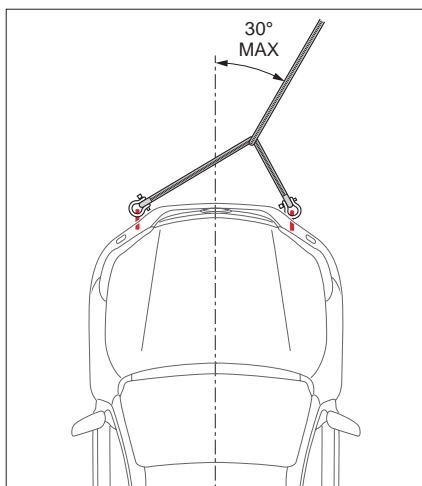

The angle of the recovery strap should not exceed the turning angle of the front wheels.

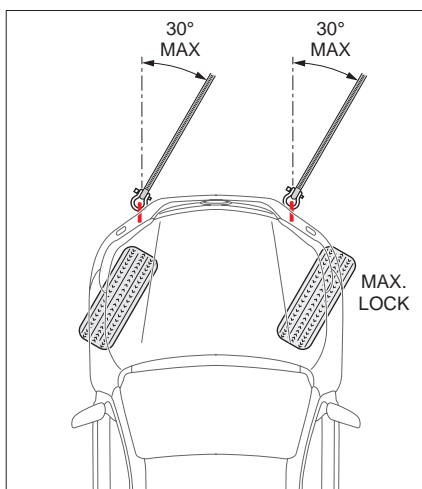

Rear recovery points

The rear recovery points are integrated with the vehicle's tow bar and can be found on either side of the tow bar. They are designed to distribute the large recovery loads through the chassis frame.

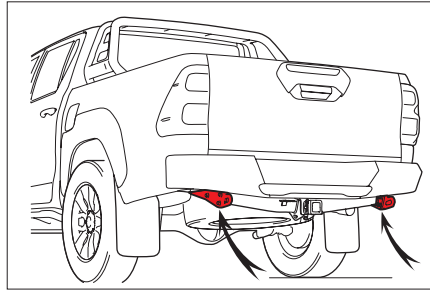

The recovery points are designed to be used in unison, using a bridle to spread the load between both points and the chassis of the vehicle.

The angle of the recovery strap should not exceed thirty degrees from the centre line of the vehicle for the rear recovery points.

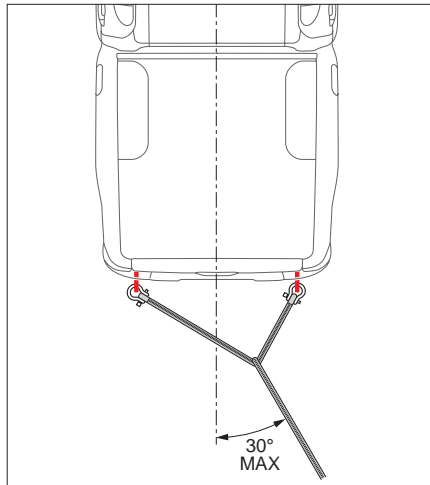

NOTICE

The tow bar is designed to handle towing loads and not recovery loads. Do not attach recovery loads directly to your tow bar, other than via the recovery points.

Tow bar

Your vehicle is fitted with a tow bar and is supplied with a compatible tongue and ball.

It is also fitted with a trailer wiring harness mounted to the tow bar. Use the appropriate mating plug when connecting a trailer and use a Toyota Genuine converter if the trailer uses a different type of connection.

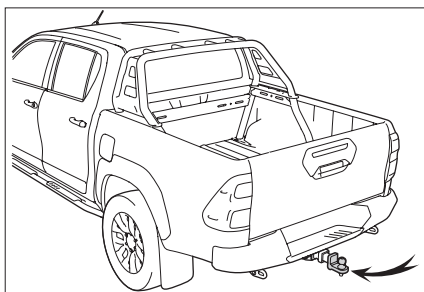

- The tow bar capacity is subject to regulatory requirements and will depend upon your vehicle design and towing equipment limitations. Please refer to the Trailer Towing section in the main Owner's Manual to determine the towing capacity of your vehicle. Before towing you should ensure that the total combined trailer weight, gross vehicle weight, gross axle weights and trailer tongue load of your individual vehicle does not exceed towing capacity.
- You should refer to the tongue label information before fitting the tow bar tongue. This will show you the correct orientation for fitting the tongue to your vehicle. The tongue should be secured with the pull pin and R-clip provided.

Sports bar

Your vehicle may be fitted with a tub floor mounted sports bar. It is designed to:

- Carry a maximum load of 75 kg

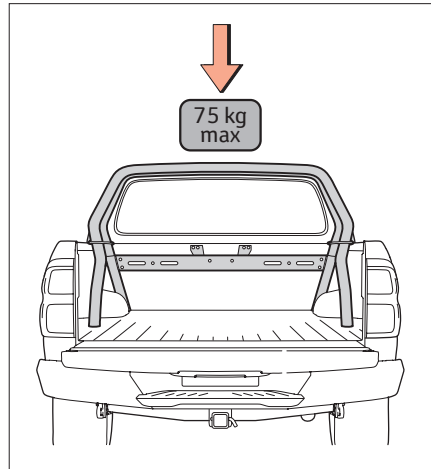

- Hold a maximum tied down load of 200 kg

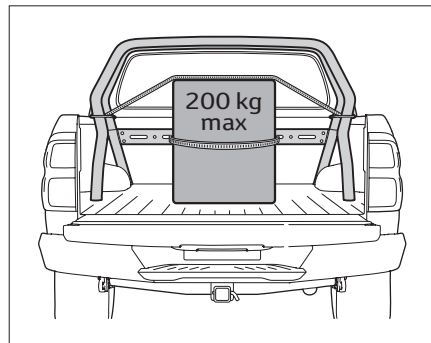

Heavy duty rock rails (if equipped)

Heavy duty rock rails mounted directly to the chassis rail are fitted to protect the rocker panels from ground impacts when the vehicle is used off-road.

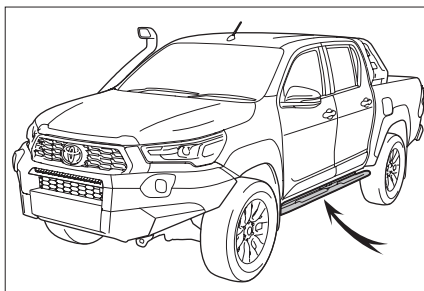

Roller cover and resin sports bar (if equipped)

WARNING

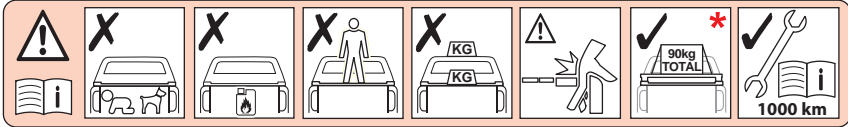

- DO NOT use the vehicle tub as a passenger compartment. In case of accidental entrapment:
 - i. Disengage the roller cover motor by depressing the clutch release lever (glowing) located near the motor housing (front of vehicle tub).
 - ii. The cover can now be retracted by hand, refer to page 20.
- DO NOT store or transport volatile materials, such as solvents, chemicals or liquids as fumes may accumulate inside the tub. DO NOT allow solvents, chemicals or oils to come in contact with the roller cover. If this should occur clean the roller cover immediately with a mild detergent and water solution.
- DO NOT fill or store volatile liquid containers such as fuel cans under the roller cover.
- DO NOT stand/sit or rest heavy objects on the roller cover.
- A maximum weight of 90kg can be mounted on crossbars fitted to the roller cover side rails (crossbars available separately).*
- VEHICLES FITTED WITH A BED LINER: Static electricity can cause fire when fuel is pumped into ungrounded fuel containers or equipment (e.g. motorcycles, chainsaws etc.). DO NOT fill fuel containers or equipment in the vehicle tray as static electricity can cause fuel to ignite, resulting in damage, injury or death. To avoid electricity build-up, place the fuel container or equipment on the ground before filling.
- DO NOT drive the vehicle with the roller motor clutch disengaged. A free moving roller cover may move causing injury or damage to property whilst driving.
- The cover is designed to be water and dust resistant in most situations. In certain extreme environments a certain level of ingress is to be expected. Items that are of high value and are susceptible to water damage should be packaged accordingly. Condensation on the under side of the roller cover should be expected under certain conditions (cool days/nights).
- DO NOT subject the slats/hand rail to excessive open/close forces as excessive force may damage internal components.

⚠ WARNING

- While the roller cover has a built in safety feature to prevent damage and injury, you must keep obstructions clear of the cover during opening/closing.
- To ensure your electric roller cover continues to operate in a trouble free manor we recommend to recalibrate the cover every 6 months, refer to page 20. This interval may be reduced if you notice any irregularities when opening or closing the cover.

The roller cover functions can be operated using the following procedures.

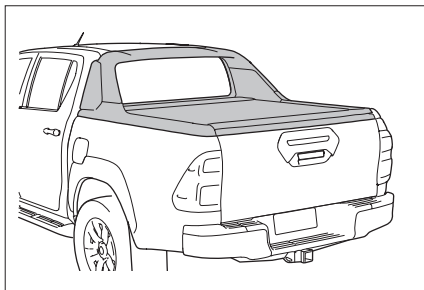
**Locking and unlocking**

The roller cover will lock and unlock with the vehicle's central locking. Consult your vehicle's Owner's Manual for instructions on operating the central locking system.

NOTE: The vehicle auto lock function will be disabled after the roller cover is fitted.

Sleep mode

The roller cover is designed to shut down after 12 hours without use to save battery life.

If the roller cover, LED's and 12V socket are not operating, unlock the vehicle to wake the system and regain normal operation.

Opening and closing

NOTE: Ensure the roller cover is unlocked before operating the controls.

To open: Press the forward OPEN button.

To close: Press the aft CLOSE button.

To stop: Press either the OPEN or CLOSE buttons.

NOTE: The roller cover can be operated using the buttons on either side of the vehicle.

The roller cover will stop automatically when either fully opened or fully closed.

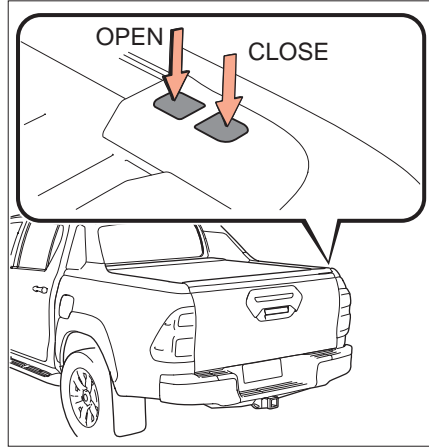

Luggage compartment light

The luggage compartment light has 3 modes of operation:

AUTO: Turns the light on for 2 minutes after the roller cover is operated and open.

ON : Turns the light on for up to 20 minutes.

OFF: Deactivates the light.

Press the button on the light to cycle between AUTO – ON – OFF.

NOTE: A small blue LED next to the button will illuminate when in AUTO mode.

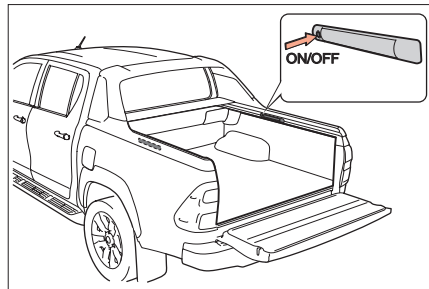

Emergency opening procedures

The roller cover can be manually overridden by:

- 1. Disengaging the motor clutch as shown.
- 2. Pulling the roller cover open by hand.

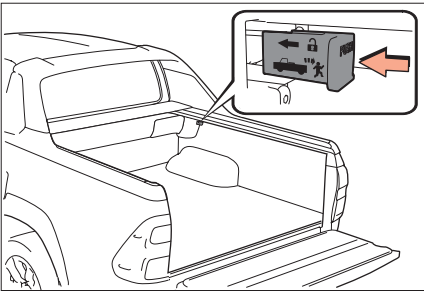

Calibration procedure

In the event the roller cover fails to open and close fully, preform the following steps to re-calibrate the roller cover:

- 1. Ensure the roller cover is clear of obstacles, can open and close fully and manual override is not engaged.
- 2. Press the OPEN and CLOSE buttons together for 10 sec.
- 3. Wait for the automatic calibration process to complete.

While the calibration process is in progress, the LED illumination lamps will flash and the roller cover will perform the following:

Close Fully > Open Fully > Close Fully > Open Fully > Close slightly to its default open aperture.

- 4. Calibration is complete when the LED illumination lamps stop flashing.

Diagnostic code table

Interior Light	Roller Cover	Status
Flashing	Slowed Opening / Closing	Low battery voltage
Not operating	Normal Opening / Closing	Check interior light mode
–	Not fully Opening / Closing	Re-run calibration procedure
–	Not opening	Ensure vehicle is unlocked

Cleaning the canister

The canister stores the roller cover when opened.

The canister has two inspection points for cleaning any leaves and debris collected inside the canister.

With the roller cover open, unscrew the inspection cover to gain access to the canister.

Remove all larger debris by hand and use a brush or hose with water to remove any small particles.

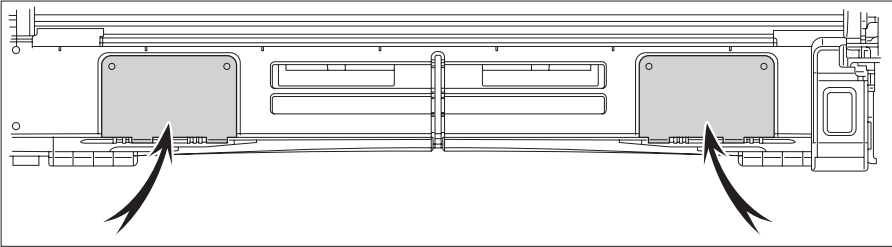

Ensure water flows freely from all four drain tubes.

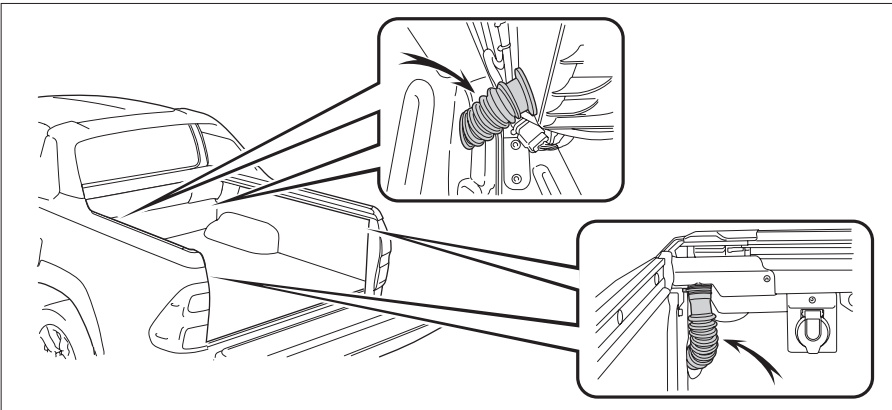

12 volt power socket - tub (if equipped)

12 volt power socket

A 12 volt power socket may be available at the rear of the tub.

Voltage: Battery Voltage,
unregulated with low
voltage protection.

Current: 15A maximum.

Power is available at all times
unless the battery voltage drops
below 12.1 volts.

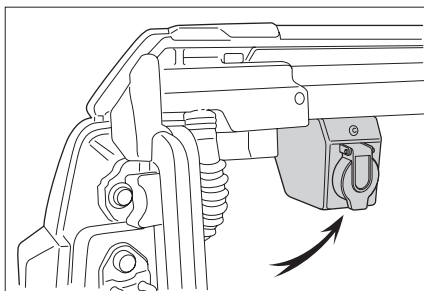

12 volt power socket battery management system

■ Locating the battery management system

- ① Unclip the glove box dampener (if equipped)
- ② Remove the LHS retaining clip by rotating anti-clockwise
- ③ Remove the glove box

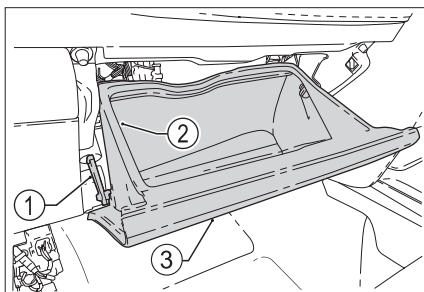

The battery management system module is located on the left hand side of the glove box opening.

The battery management system module provides the following functions:

- Low battery voltage protection
- Over voltage protection
- Over current (load) protection

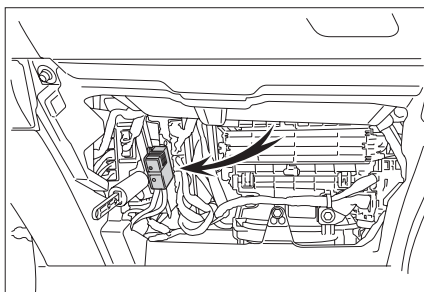

■ Diagnostic code table

The LED lamps on the battery system management module indicate the status of the tub 12 volt power socket.

Blue LED	Red LED	12 V Socket	Status
OFF	ON	OFF	Insufficient battery power
BLINK (0.5 sec)	OFF	OFF	Over-voltage protection
OFF	BLINK (0.5 sec)	OFF	Over-current protection
ON	ON	ON	Open circuit (no load connected/detected)
ON	OFF	ON	Operating on normal condition (min 400mA)
ON	BLINK (0.5 sec)	ON	Operating with battery

Tub tray and tailgate protection (if equipped)

The tub tray is designed to protect the load area from normal wear and tear.

The tub tray can be removed from the vehicle.

Removing the tub tray

To remove the tub tray remove the screws and dislodge the tape from the underside of the tub tray. Take care when disengaging the tray from around the sports bar.

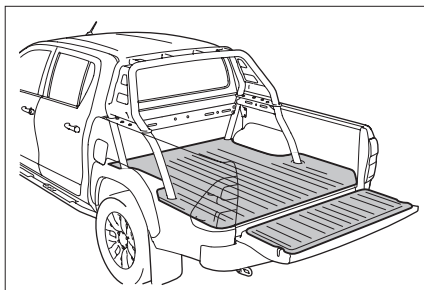

NOTICE

The tail gate protector is not designed to be removed.

Textile liner (if equipped)**NOTICE**

The textile liner is not designed to be removed.

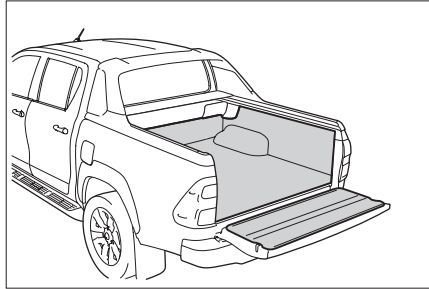

Cleaning and protection of the vehicle

Decal maintenance

■ Caring for the decals

Special care must be taken to avoid abrading or scratching the decal. Scratching and abrasion marks may be visible and you may not be able to work them out of the unique finish of the decal. To help avoid such damage, avoid using harsh chemicals, brushes or hard scrubbing when cleaning your vehicle.

Use a cleaner designed for high-quality painted surfaces. The cleaner must be wet, non-abrasive, without strong solvents, and have a pH value between 3 and 11 (neither strongly acidic nor strongly alkaline).

Rinse thoroughly after cleaning and dry with a clean, soft cloth or soft rubber squeegee to avoid water spots.

Do not apply waxes, polishes, paint or clear coat over these decals.

DECAL LOCATIONS

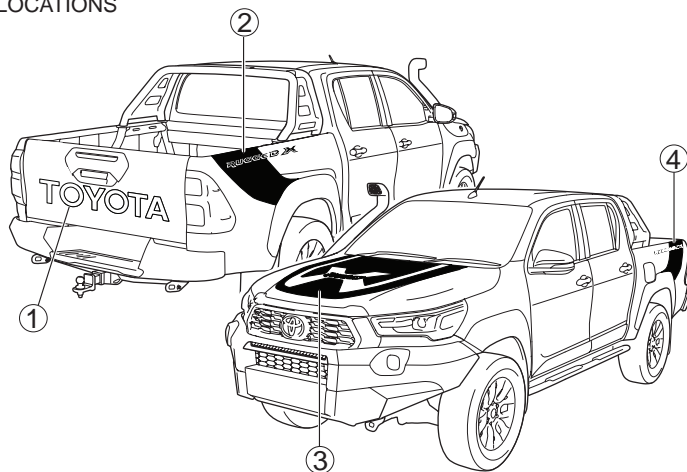

■ Power washing decals

Power washing or pressure washing may be used. However, aggressive washing can damage the decal. Excessive pressure during power washing can damage the decal by forcing water underneath the decal. Water lessens the adhesion of the decal to the substrate allowing the decal to lift or curl. These problems are magnified by wind. To avoid edge lifting or other damage to the decals, follow these important steps:

- Use a spray nozzle with a minimum 40 degree wide spray pattern.
- Use a maximum pressure of 1200 psi (80 bar).
- If the system is heated, limit the water temperature to 60°C (140°F) or less.
- Hold the nozzle at least 300 mm away from and perpendicular (90° angle +/- 10) to the decal or a minimum of 1 metre away from the decal at a 30° angle, or higher.
- Do not direct the water stream between 0°-60° to the edge of the decal.

Cleaning, maintenance and servicing of the resin sports bar and roller cover

- Your roller cover is designed for years of maintenance free operation, however in certain conditions additional care may be required to ensure smooth operation. If the vehicle is driven in extreme conditions (hot/cold/dust) then maintenance intervals should be reduced.
- Regularly wash the cover. Only use mild detergents, liquid wax or general purpose cleaner to clean the roller cover. Avoid the use of products containing alcohol as these can damage the painted surface.
- DO NOT use abrasive compounds on painted or plastic finished cover surfaces.
- Use only graphite powder to lubricate locks and lock recesses. DO NOT use any other lubricants or oils.
- Regularly open the inspection covers and remove any debris from the canister. Hose with water to wash debris from the canister and ensure water flows freely from the drain tubes, refer to page 21.
- Regularly inspect all four drain tubes for damage or splitting, refer to page 21.
- Regularly clean the side rail seal, side rail glide strips and canister drive plates with water and mild detergent.

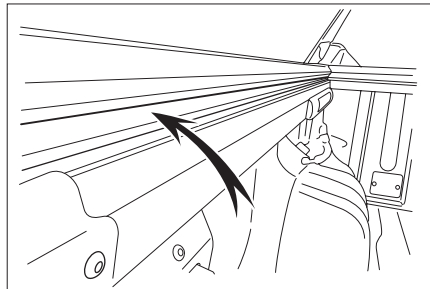

- If you notice slow, heavy or noisy operation of the cover firstly clean the externals of the roller cover (slats, side rails, seals, etc.) and the internals of the canister as described on page 27. Allow the product to dry thoroughly.

With the service covers open and the slats in the fully closed position apply a coat of plastic compatible 100% liquid silicon spray to the spiral shaped internals of the canister end plates **ONLY**.

Open and close the cover several times to ensure lubricant is dispersed over all moving parts. Refit the service covers and recalibrate the roller cover if required, refer to page 20. **DO NOT** use any other lubricants or oils.

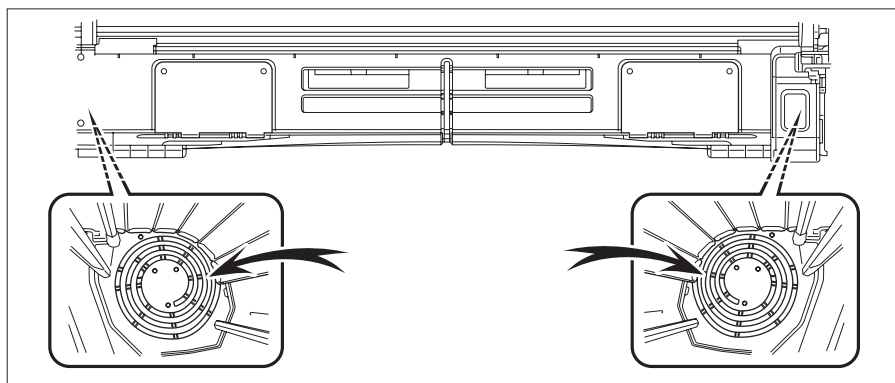

Cleaning the tub tray and textile liner

- Remove dirt and dust using a vacuum cleaner.
 - Dirty surfaces can be washed with a cloth dampened with warm water. A small amount of household detergent can be added to the water if necessary.
- After cleaning thoroughly wipe off remaining traces of detergent and water.

Vehicle specifications



WARNING

Vehicle weights/mass and dimensions are approximate and subject to individual vehicle variances. Vehicles should be individually weighed and measured before fitting any accessories, towing or designing any compatible trailer/caravan or otherwise using the vehicle in any way that depends on this value.

Gross axle weight

The load on either the front or rear axle resulting from distribution of the gross vehicle weight on both axles must not exceed the following:

■ Rugged X (with bullbar)

Front: 1550 kg

Rear: 1700 kg

■ Rogue (without bullbar)

Front: 1480 kg

Rear: 1700 kg

Maintenance data

Dimensions

Overall length	Rugged X	5350 mm * ¹
	Rogue	5325 mm * ¹
Overall width	Rugged X	1935 mm
	Rogue	1900 mm
Overall height* ²	Rugged X	1815 mm
	Rogue	1795 mm

*¹: Without tow bar tongue

*²: Unladen vehicle

Alphabetical index

C

Cleaning and protection of the vehicle 26

Cleaning, maintenance and servicing of the resin sports bar and roller cover ...27

Cleaning the tub tray and textile liner26, 28

Decal maintenance26

Cleaning the canister21

D

Dimensions..... 30

F

For your information 4

G

Gross axle weight 29

H

Heavy duty rock rails.....16

L

LED Driving lights 9

LED light bar levelling9

Turning off the LED driving lights9

Turning on the LED driving lights9

M

Maintenance data 30

Dimensions30

P

Pictorial index 6

Exterior6, 7

Interior8

Power socket, 12 volt - tub 22

12 volt power socket battery management system22

R

Reading this manual 5

Recovery points 11

Fitting bow shackle11

Front recovery points 12

Rear recovery points 13

Resin sports bar17

Roller cover17

Calibration procedure20

Cleaning the canister 21

Emergency opening procedures.....20

Locking and unlocking 18

Luggage compartment light..... 19

Opening and closing..... 19

Sleep mode 18

Alphabetical index

S

Snorkel.....10
Care instructions 10
Rotating the snorkel head 10
Sports bar.....15

T

Table of contents 3
Textile liner..... 25
Tow bar.....14
**Tub tray and tailgate
protection 24**
Removing the tub tray24

V

Vehicle specifications 29
Gross axle weight.....29





Publication No. TSO2001
Issue: 2005-00