



PRADO

Kit Part No: PZQ59-60140
August 2017 Production Onwards
Fitting Time: 60 minutes

Driving Lamp Harness

Fitting Instructions

Tail Patch Harness (PZQ59-00170) will need to be purchased separately and installed during this installation.

– General Notes

- Read through the fitting instructions before installation of accessory.
- Always install the accessory following the fitting instructions. Failure to do so may cause damage to the vehicle or the accessory.
- Ensure all recyclable discarded vehicle accessory components and packaging are recycled following local recycling regulations.
- It is always recommended that this accessory is fitted by a qualified Toyota Technician.
- Safely store and protect any removed vehicle components.
- Ensure all bare metal surfaces are protected using Automotive Bare Metal Primer and touch-up paint.
- Remove all metal swarf and dust from all vehicle surfaces if surface is used for accessory installation.

– Safety Notes

- Check that all work practices comply with safety standards.
- Please wear appropriate clothing and use safety equipment.



– Fitting Time



60 minutes

– Parts Supplied

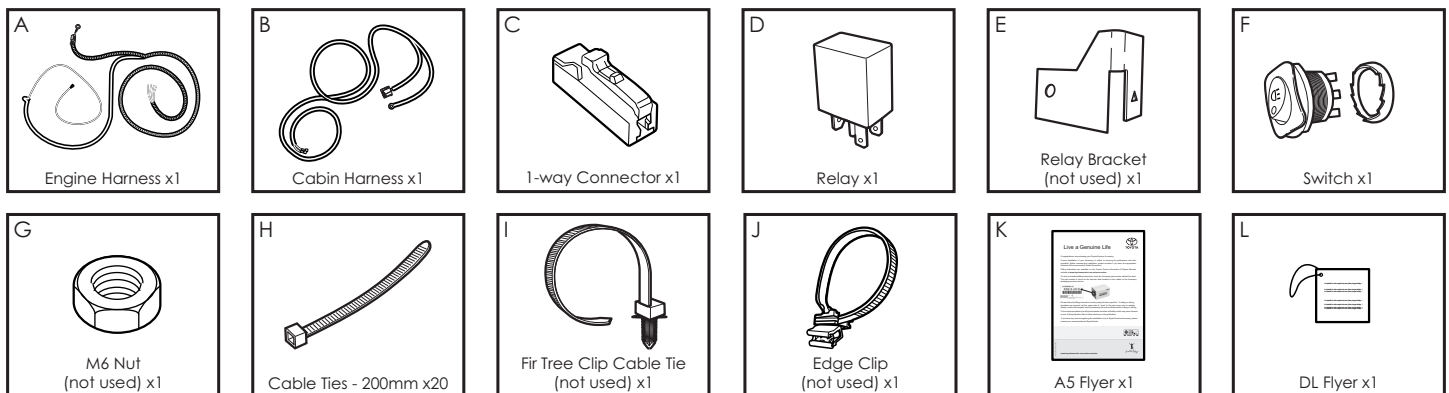

– Additional Required Parts

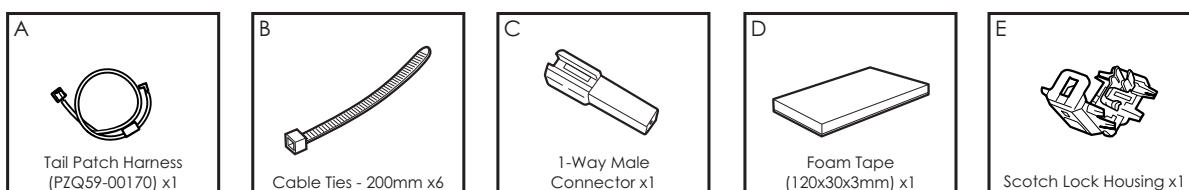

– Tools and Materials Required

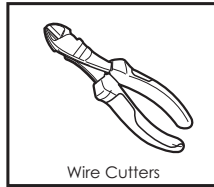
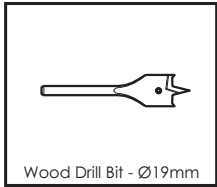
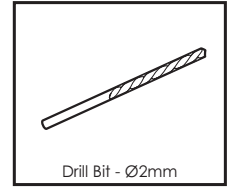
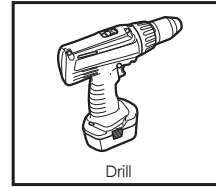
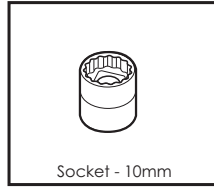
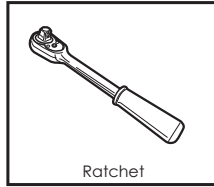
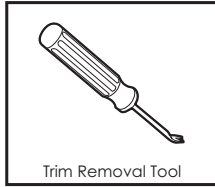
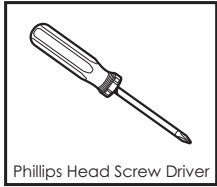

– Step 1

Important



Always refer to the vehicle's Workshop Manual when removing vehicle components.

- Fully extend the steering wheel in its most upward and pulled out position.
- Note down all clock and radio settings.
- In the engine bay, disconnect the battery negative terminal.
- Remove the grille upper thirteen trim fasteners (1) and remove grille upper trim (2).

Always refer to workshop manual for assistance with part removal.

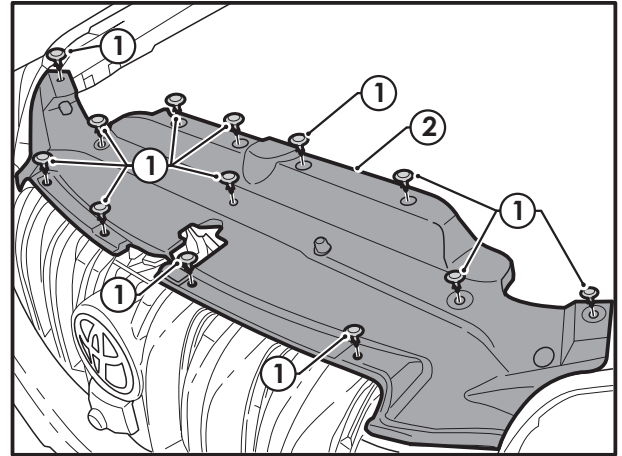

– Step 2

- Remove the four hex bolts (1) and unclip and remove the grille (2).

Note: If there are connectors (3) available, disconnected before removing grille.

Always refer to workshop manual for assistance with part removal to avoid damaging the grille.

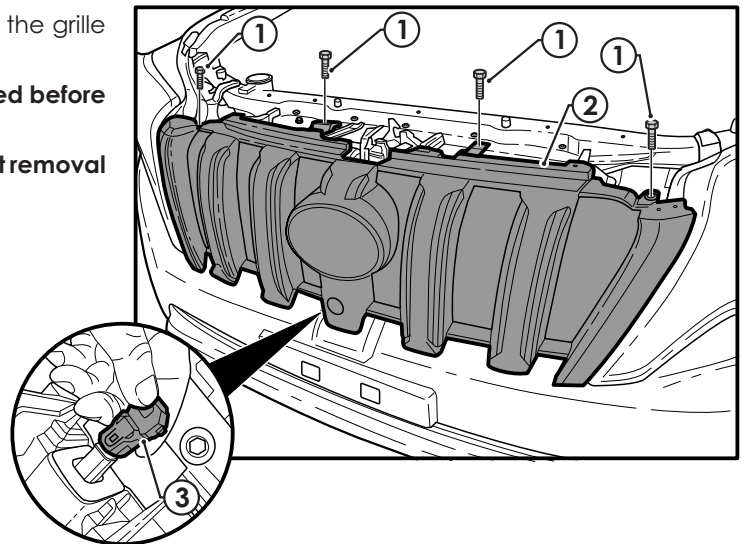

– Step 3

- Remove the following six fasteners (1) from underneath the front bumper (four bolts and two hex screws).
- Remove the four clips (2) at the top of the bumper (3).
- Remove the two hex screws (4) from each side at the edge of the wheel arch.
- If fitted, disconnect fog lamp/park assist connector (5) and headlamp washer system (6).

Important



Clamp and disconnect headlamp washer hose with flexible hose clamp. Do not use serrated tooth clamp.

- Disconnect the 8-way connector and remove the front bumper (3).

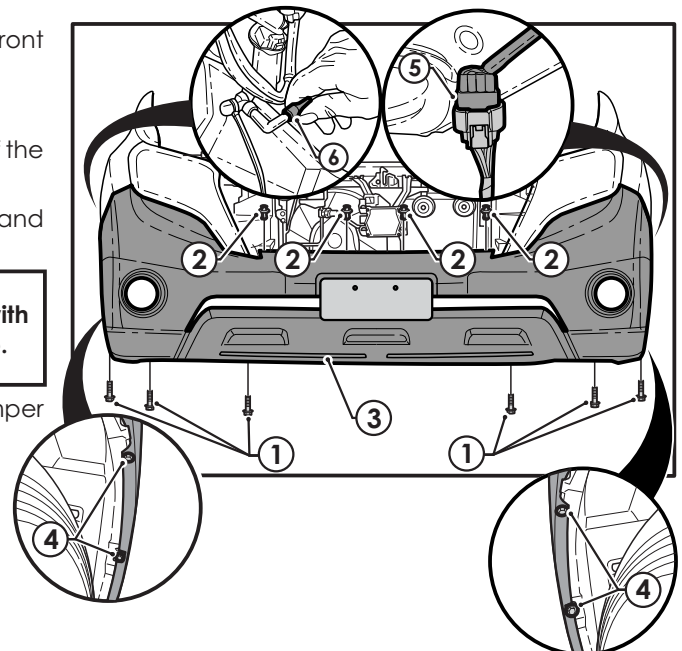

– Step 4

- On the front passenger side of the vehicle, remove the door sill trim **(1)** and kick panel **(2)** by releasing the fastener **(3)**.
- Dislodge the rubber door seal **(4)** to expose the side trim on the instrument panel.

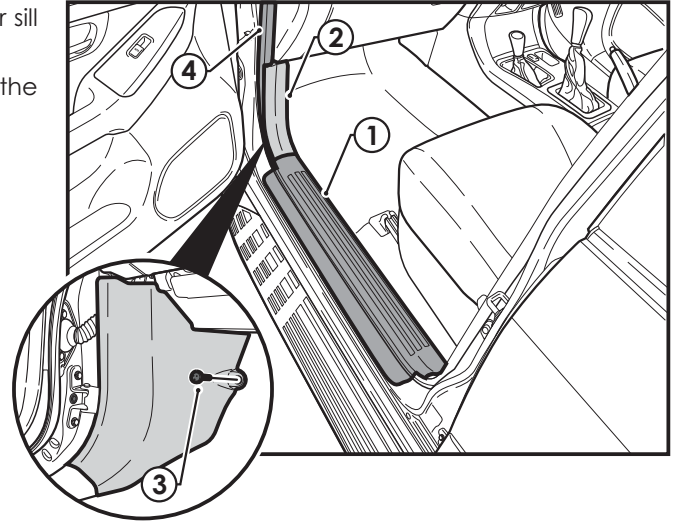

– Step 5

- Remove the glove compartment upper trim **(1)**.
- Remove the LHS instrument panel side trim **(2)**.

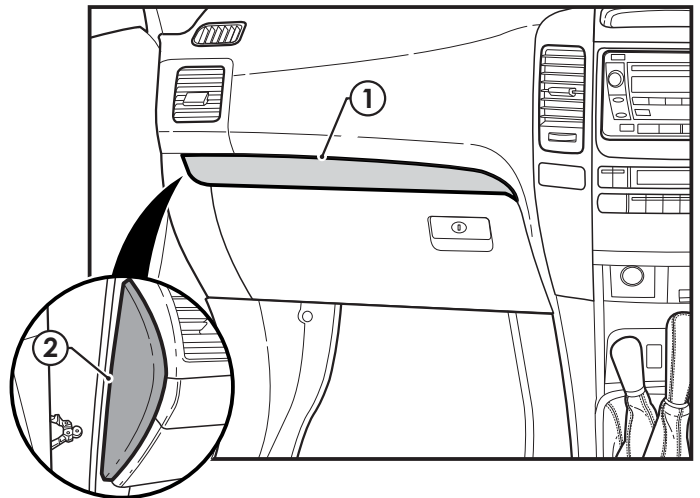

– Step 6

- Release the phillips head screw **(1)** and remove the glove compartment lower trim **(2)**, unclipping the lamp if present.
- Remove the glove compartment along with the inner trim **(3)** by removing the hex bolts **(4)** and two hex screws **(5)**.
- Unclip the inner lining lamp.

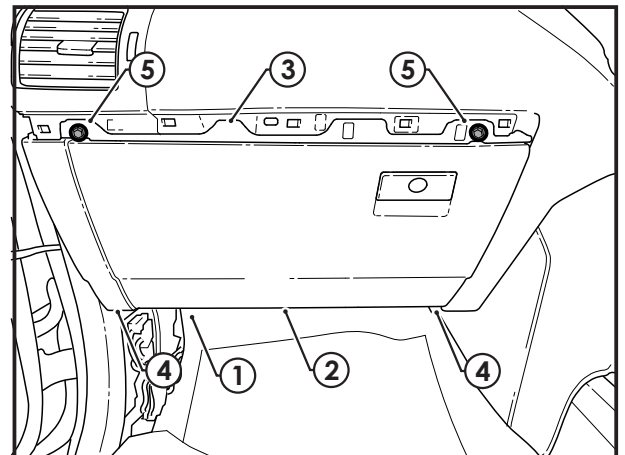

– Step 7 –

- Dislodge and remove the HVAC control panel (1) and then disconnect any control panel connectors.
- Remove the centre console side trims (2).

Always refer to workshop manual for assistance with part removal.

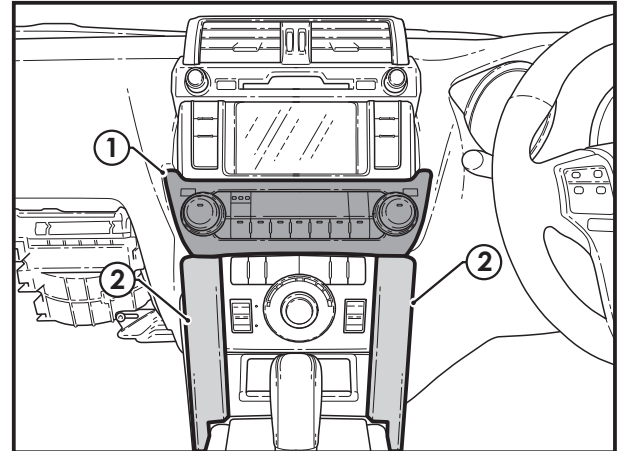

– Step 8 –

- Remove the four hex bolts (1).
- Disconnect the audio unit connectors and remove the audio unit and A/C vent assembly (2).

Always refer to workshop manual for assistance with part removal.

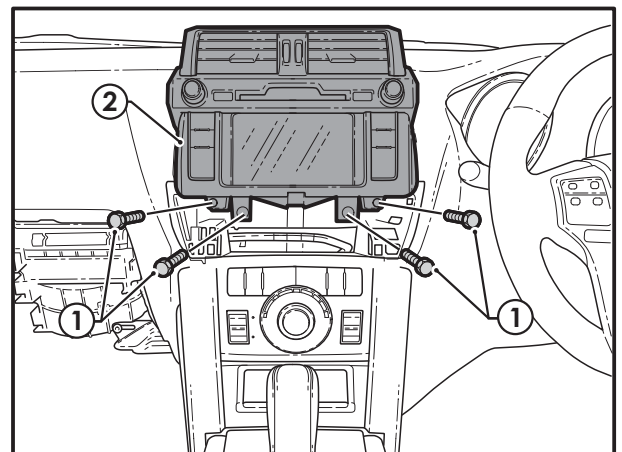

– Step 9 –

- On the driver's side of the vehicle, remove the door sill trim (1) and kick panel (2) by releasing the fastener (3).

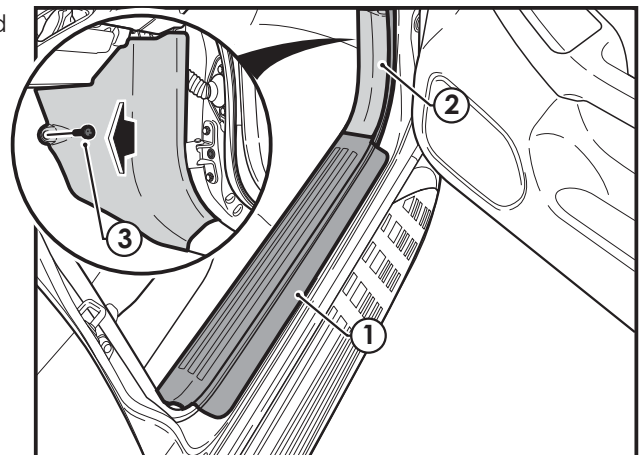

– Step 10

- Release the driver's door seal **(1)** to expose the side trim.
- Remove the driver's dash side trim **(2)**.
- Dislodge the switch panel **(3)**.
- Remove the engine start panel trim **(4)**.
- Open the fastener cover **(5)**, remove the driver's lower dash fasteners **(6)** and then dislodge the lower dash trim **(7)**.

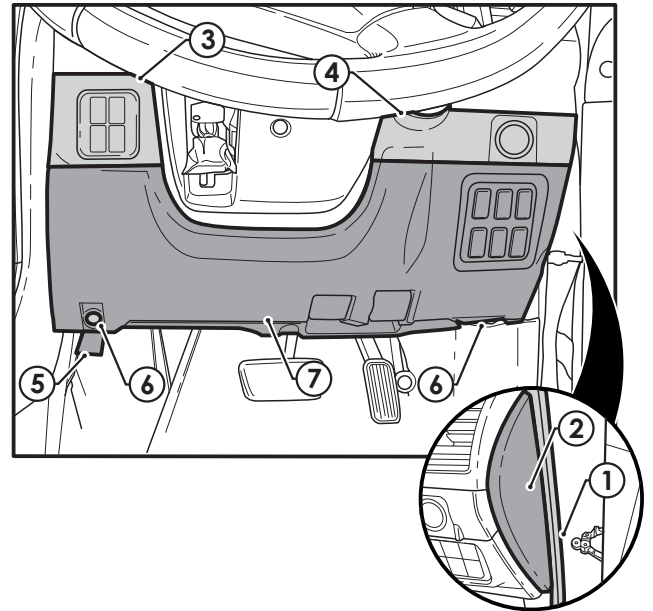

– Step 11

- Release the three phillips head screws **(1)** from the lower steering column trim **(2)** as shown.
- Remove the lower steering column trim **(2)**.

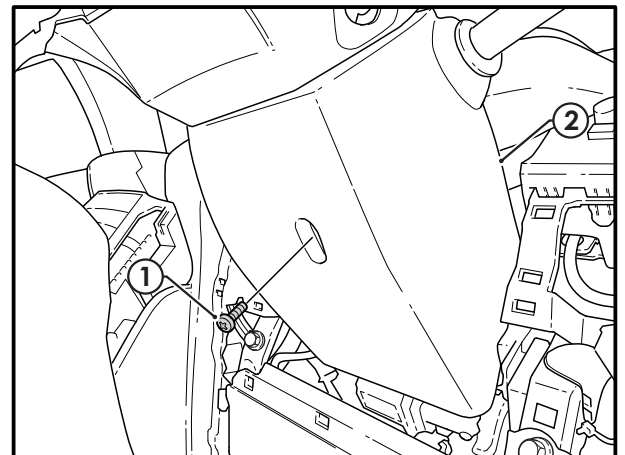
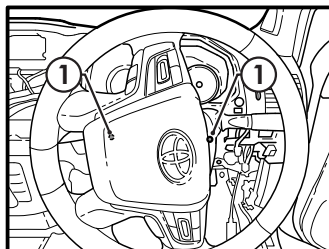

– Step 12

- In the engine bay, locate the LHS firewall grommet. Cut an access point **(1)** on the RHS nipple of the firewall grommet.
- Secure the Engine Harness **(2)** to a guide wire using tape. Feed the guide wire into the previously cut LHS access point of the firewall grommet.
- Ensure the guide wire breaks the internal seal and is fed into the LHS of the cabin until the loop **(3)** on the Engine Harness meets the grommet. Seal and secure the Engine Harness to the grommet with a Cable Tie.
- Secure the Engine Harness **(2)** to the vehicle harness using a supplied Cable Tie **(4)**.
- Discard the guide wire after routing.

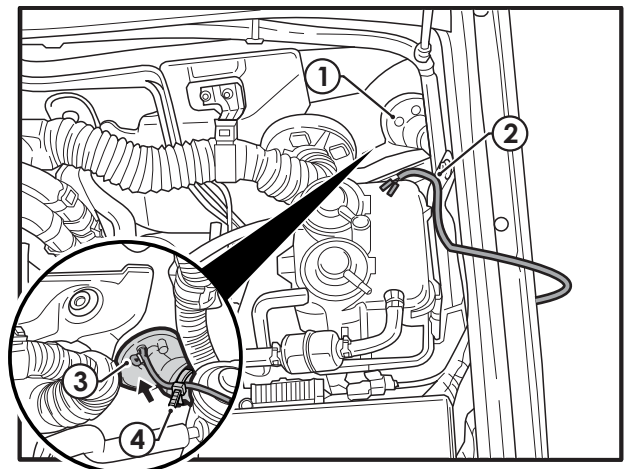

Important



In the engine bay, ensure the loop (3) on the Driving Lamp Harness is downwards. Ensure the grommet access point is sealed.

– Step 13

- In the glove compartment cavity, retrieve the Engine Harness (1) from the firewall grommet (2).
- Route the Engine Harness driving lamp terminals (3) towards the front of the glove compartment cavity area following the vehicle harness.

Important



Cable Tie Engine Harness to vehicle harness every 200mm

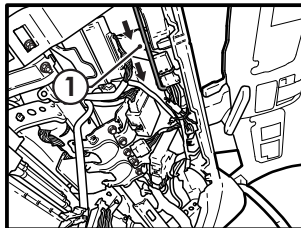

View from underneath the glove box compartment

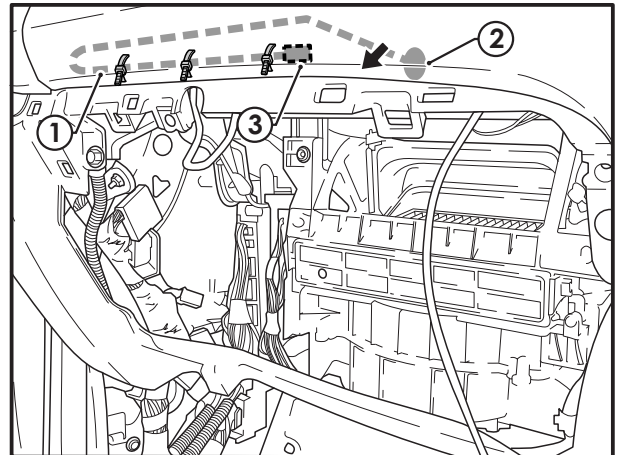

– Step 14

- House the two Engine Harness driving lamp terminals (1) into the Cabin Harness relay connector (2). House the **ORANGE** wire in position [A] and house the **RED** wire in position [B]. Then re-engage the secondary lock (3) as shown.
- House the small terminal (4) on the Engine Harness into the supplied 1-way Female Connector (5).
- Connect the empty 1-way Male Connector supplied with the Tail Patch Harness (PZQ59-00170) to the 1-way Female Connector (5).
- Secure the branch with the 1-way connector onto itself using the supplied Cable Ties.

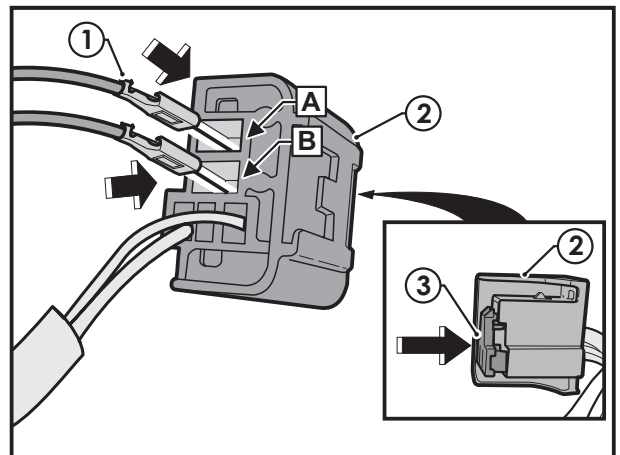
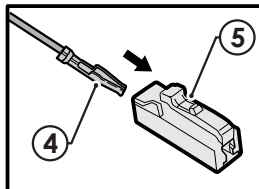

– Step 15

- Connect the supplied Relay (1) to the Cabin Harness relay holder (2).
- Connect the 1-way Female Connector (3) on the Tail patch Harness to the 1-way Male Connector (4) on the Cabin Harness.

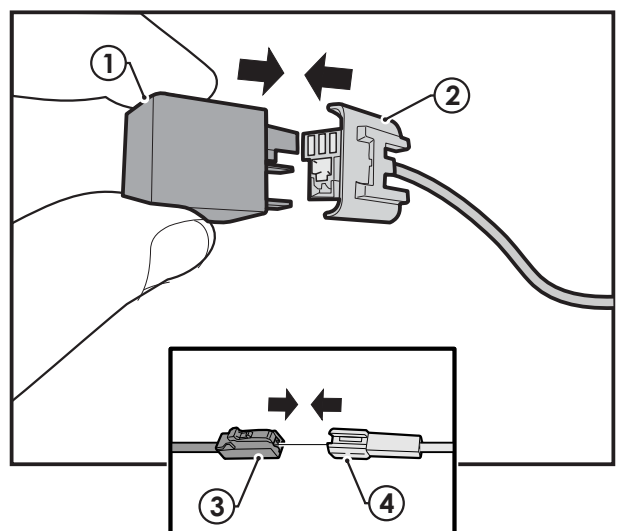

– Step 16

- Route the Tail Patch Harness (1) down to the LHS kick panel area, following the vehicle harness.
- Cable tie the harness every 200mm and ensure it is away from sharp edges.

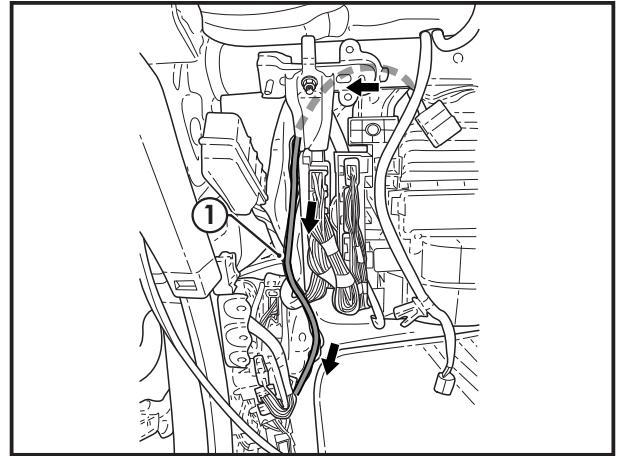

– Step 17

- Dislodge the 'WHITE' connector holder (1) to gain access to the 'BLUE' 18-way female connector (2) (located on the bottom of the connector housing).

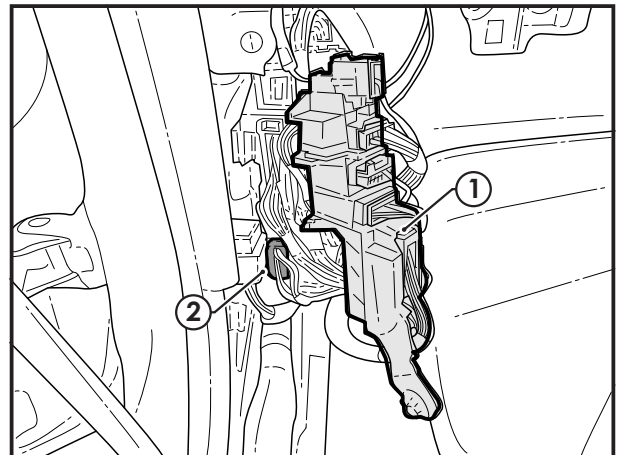

– Step 18

- Scotch Lock the Tail Patch Harness 'GREEN' wire (1) on to the 'LIGHT GREEN' wire (2) located at PIN location 16 (3).
- Secure the Tail Patch Harness to the vehicle wire harness using the supplied Cable Ties.

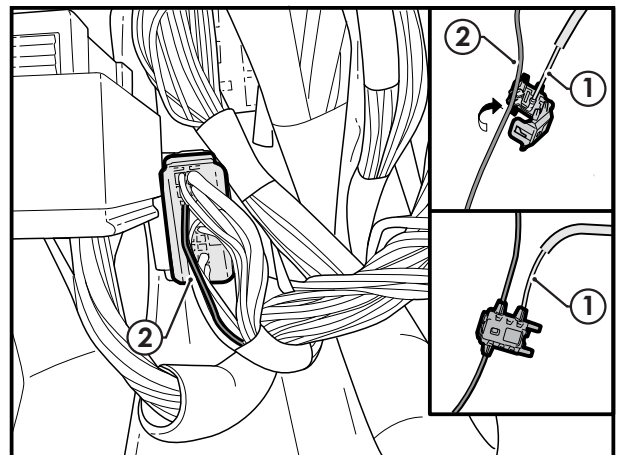
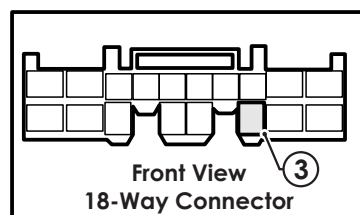

– Step 19

- In the glove compartment RHS, secure the Relay Base (1) to the vehicle harness with Cable Ties (2).
- Continue to route the Cabin Harness (3) through the audio unit cavity and towards the driver's lower dash area.

Important



Ensure to keep all harnesses clear of any moving parts or sharp edges when routing.

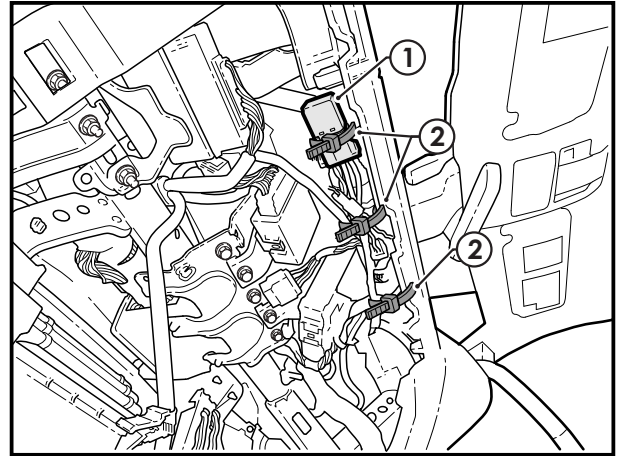
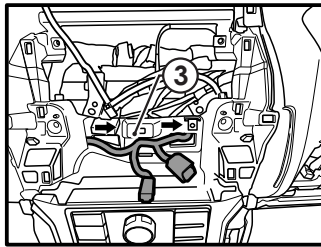
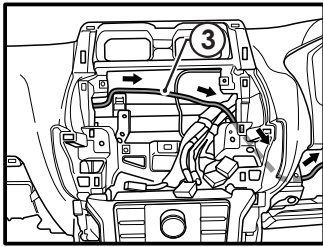

– Step 20

- Disconnect the stalk connector (1) on the RHS of the steering wheel.
- Patch the Cabin Harness (2) in between stalk connector (1) and the steering wheel.

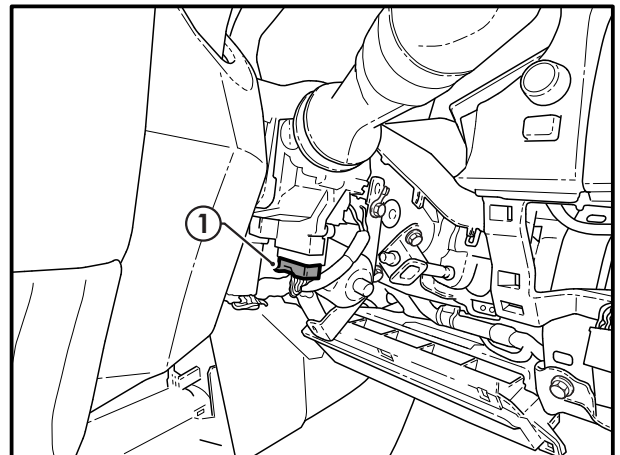
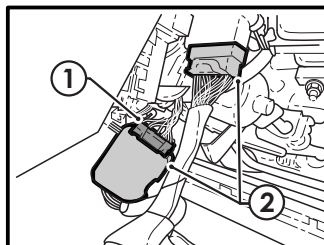

– Step 21

- Secure the lower section of the switch terminal branch (1) to the vehicle white clip mechanism (2) with a Cable Tie (3) as shown.
- Cable Tie (3) the Cabin Harness (4) to the vehicle harness just above the existing white cable tie (5) on the vehicle harness.

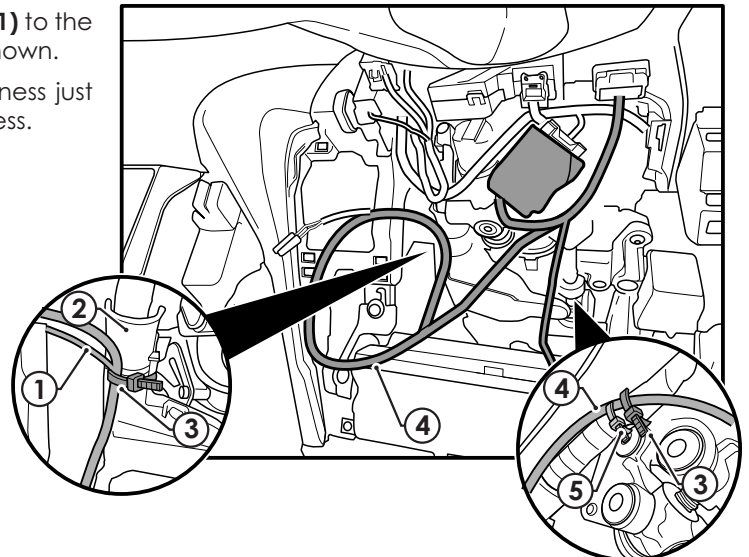

– Step 22

- Secure the excess length of the Cabin Harness (1) just below the steering wheel using a Cable Tie (2).
- Route the scotch lock branch on the RHS of the steering wheel and Cable Tie (2) as shown, allowing adequate slack.

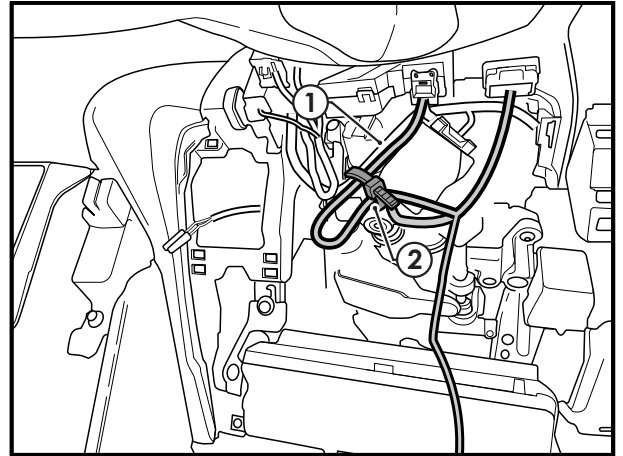
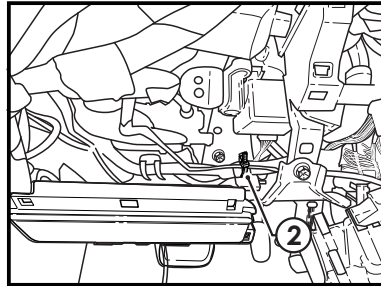

– Step 23

- Reconnect negative terminal (1) (if the steering wheel is electric).
- Move the steering wheel in all possible positions and make sure none of the harness branch is too tight in any position.
- Make sure the lower steering wheel cover can be fitted back without pinching on the harness.
- Retry all possible positions of the steering wheel and assess if enough slack is available.
- Disconnect the negative battery terminal (1) (if it has been reconnected).

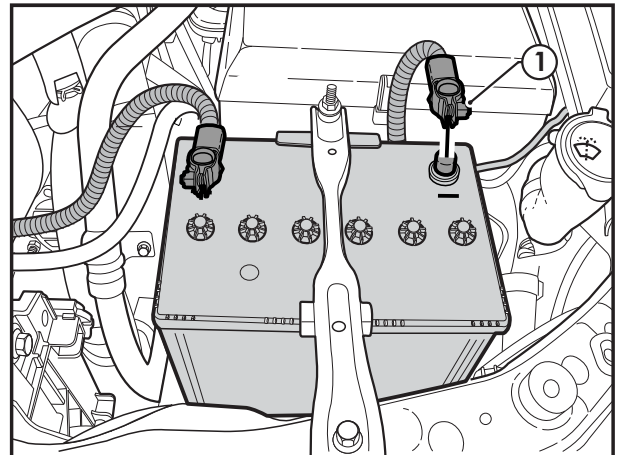

– Step 24

If vehicle is fitted with Auto High Beam feature, proceed to Step 25.
For all other vehicles continue.

- Coil the scotch lock branch onto itself and Cable Tie (1) back to the vehicle harness, (scotch lock will not be used).

Proceed to Step 26.

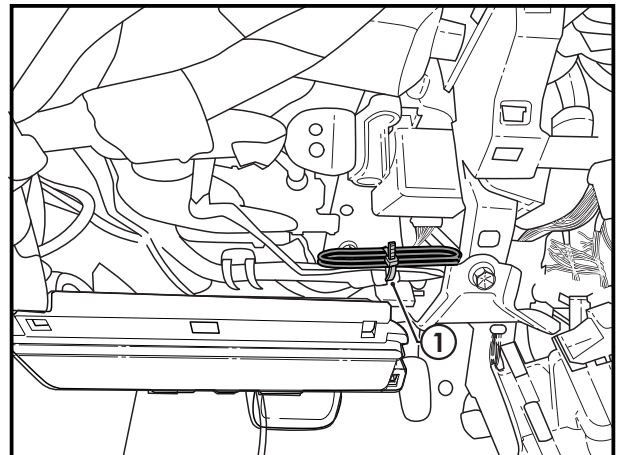

– Step 25

The following step is **ONLY** for vehicles if fitted with Auto High Beam feature. For all other vehicles proceed to Step 26.

- On the RHS of the steering column, open the Scotch Lock Housing on the Cabin Harness (1).
- Locate the BLUE 6-way connector with two 'WHITE/BLACK' wires, one 'PINK' wire and one 'GREEN' wire.
- Splice the Cabin Harness 'WHITE' wire on to the connector Pin location 5 'PINK' wire (2) using the supplied scotch lock (3).
- Secure the Scotch Lock connector to the vehicle harness using a supplied Cable Tie.
- Refit the connector back into the Switch.
- Put the Switch back into the vehicle base.

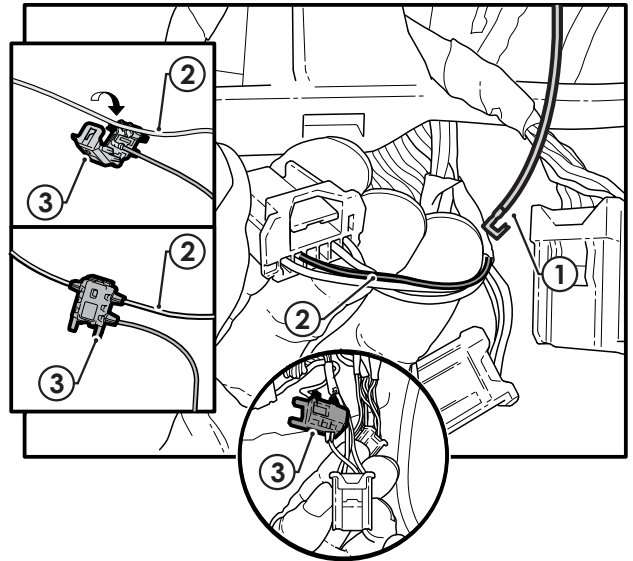
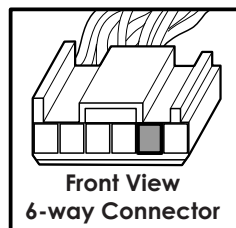

– Step 26

- Using tape, adhere Template (1) to the LHS driver's dash trim (2) and using a Ø2mm drill bit, drill a pilot hole into the drilling point.
- Discard Template after drilling.
- Drill a larger Ø19mm hole.
- Using a file, smooth and deburr any rough edges from the hole.
- Clear the ribs around the drilled hole to make sure they do not interfere with the switch nut.

Important



Use a low speed setting while drilling.

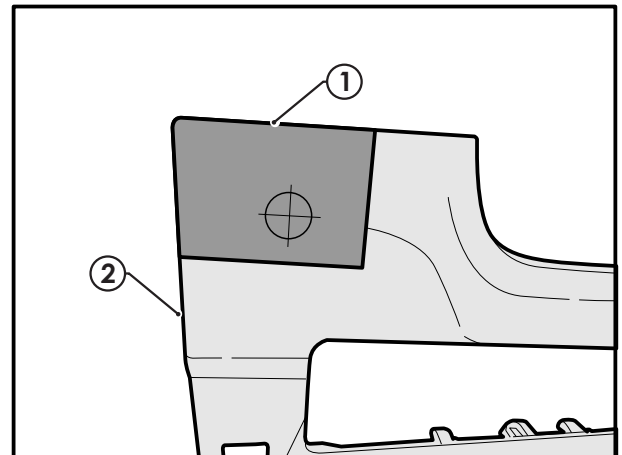

– Step 27

- Mount the switch (1) to the LHS driver's dash trim (2) and then connect the terminals (3) to the switch (1).
- Cable Tie the Cabin Harness into the instrument panel.
- Refit the driver's dash trim.

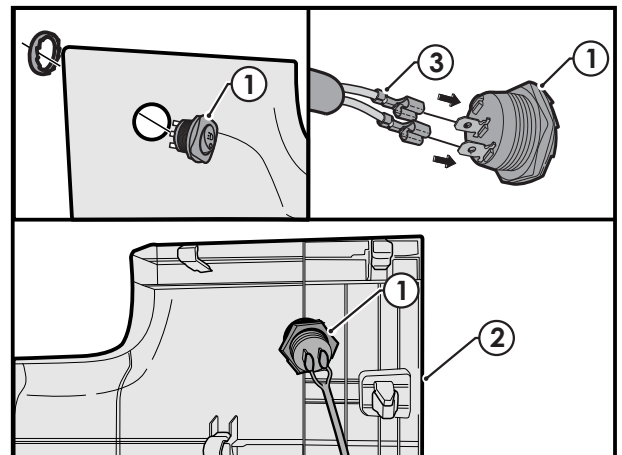

– Step 28

- Route the Engine Harness (1) as shown towards the LHS driving light assembly (2).
- Secure the Engine Harness ring terminal (3) to the vehicle earthing point using the existing bolt (4).
- Connect the positive ring terminal (5) of the Engine Harness to the positive battery terminal stud (6).

Important



Torque positive battery terminal stud to 7.5Nm ± 1.7Nm.

Important



Torque earth bolt to 8.5Nm ± 1.3 Nm.

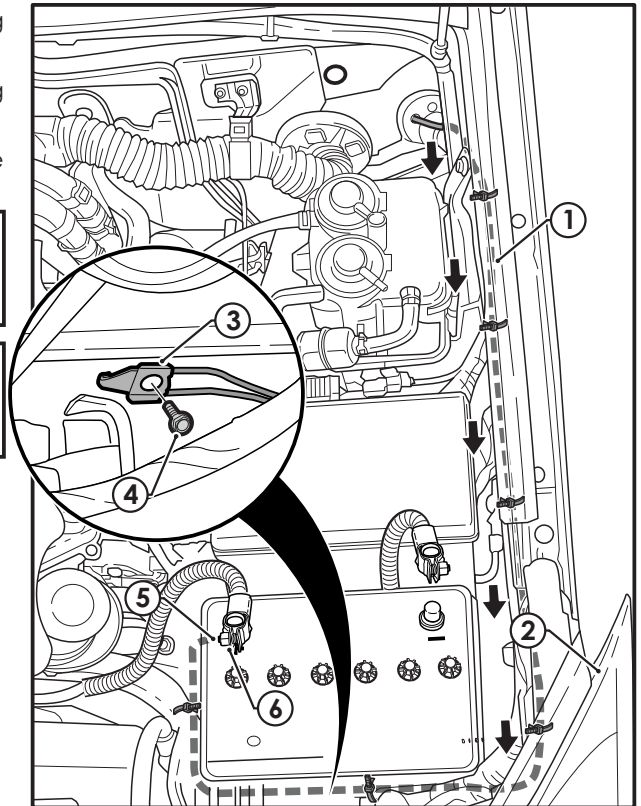

– Step 29

- Retrieve the Engine Harness from underneath the LHS headlight assembly area and route the Engine Harness (1) under the grille support as shown.
- Cable Tie (2) the Engine Harness (1) under the grille support as shown.

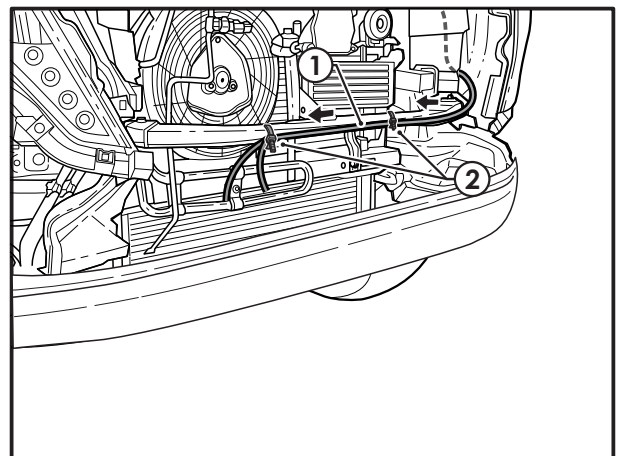

– Step 30

- Connect the LHS 2-pin female Driving Lamp Harness connector **(1)** to the LHS Driving Lamp connector **(2)**. Ensure an audible "click" is heard.
- Secure the Driving Lamp Harness to the support arm every 200mm.

Repeat for the RHS.

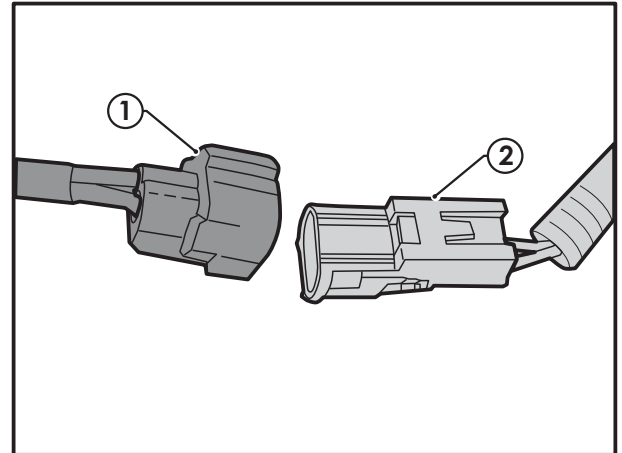

– Step 31

- Mount the Driving Lights onto the bullbar by referring to the Driving Lights fitting instructions.

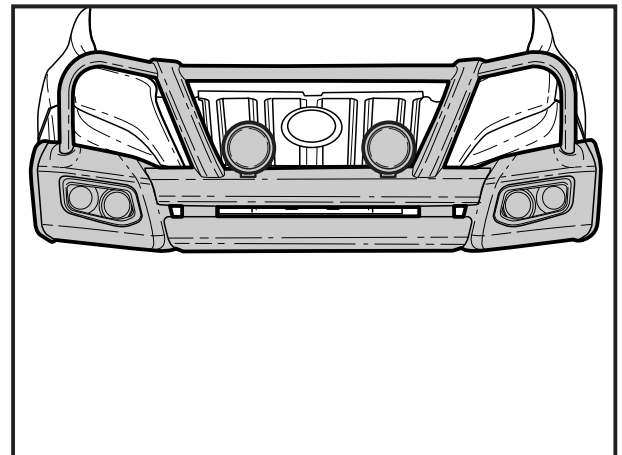



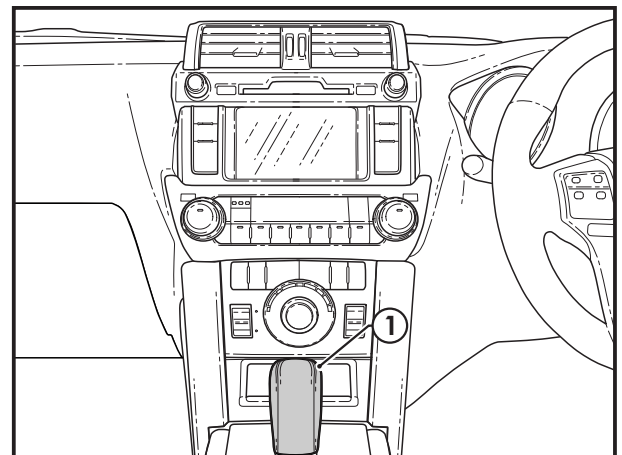

– Step 32

- Attach the supplied driving light flyer to the gear knob **(1)** of the vehicle.



— Step 33 —

- Reconnect the battery negative terminal (1).
- Test the Driving Lamp Harness system for correct operation.
- Turn the ignition to the "OFF" position.

Important 	Post terminal torque to $6.5\text{Nm} \pm 1.3\text{Nm}$
Important 	Refit all removed parts and secure all fasteners to the Service Manual torque specifications.
Important 	Reprogram all radio stations and clock settings by referring to the vehicle's owner manual.
	Please place the Fitting Instructions in the glove box after installation is completed.

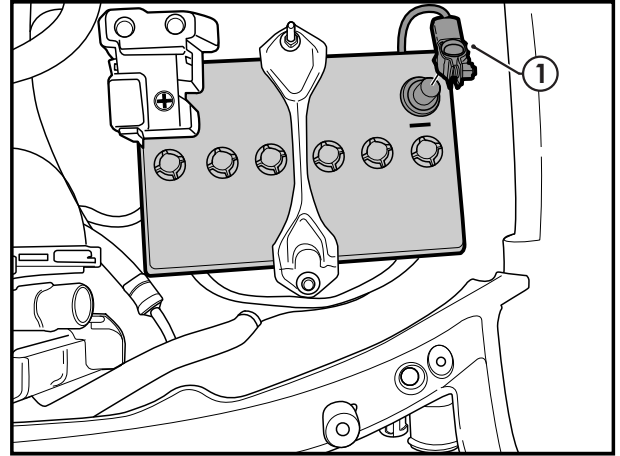

- Harness Diagram

